

TRANSFLUID



TRANSFLUID[®]

industrial & marine



drive with us

MFO
MECHANICAL POWER TAKE OFF

The **MFO** mechanical power take-off consists of a lever actuated clutch with a shaft and bearings mounted in a rigid cast housing. It is designed for inline and sideload applications for internal combustion engines with standard SAE industrial flywheel/flywheel housing dimensions.

With the exception of MFO 110 all remaining models are assembled with KEVLAR® DISCS for heavy duty and torsionally active applications.

MFO mechanical power take-offs will allow:

- to simplify installation time (no pilot bearing alignment required)
- to increase uptime and engine life
- to reduce inventory

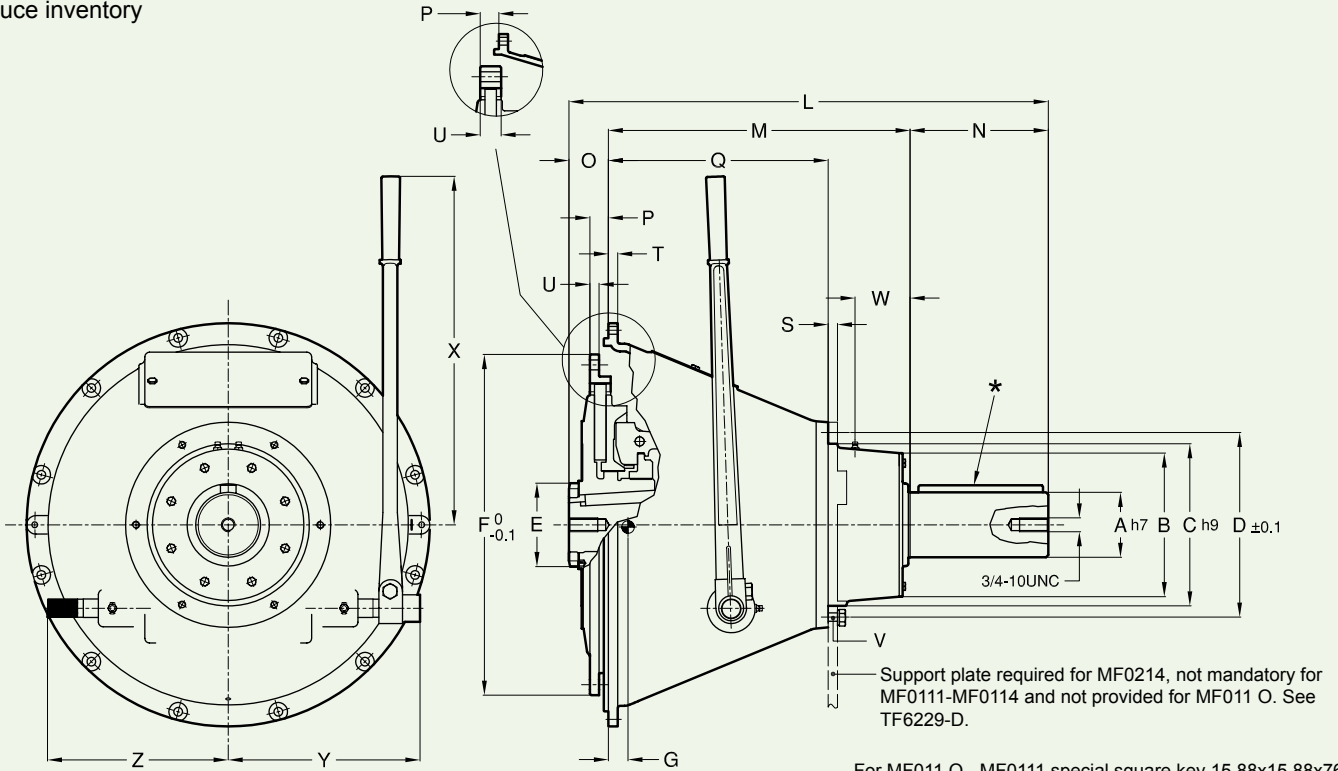

* For MF011 O - MF0111 special square key 15.88x15.88x76.2
For MF0114 - MF0214 key as per ANSI B92.1 USAS square

Dimensions (mm)

Size	SAE housing size	SAE flywheel size	A	B	C	D	E	F	L	M	N	O	P	Q	S	T	U	V		W	X	Y	Z
																		Nr.	Dia				
MF0110	4	10"	57.15	146.05	165.1	-	58	314.33	415.93	251.6	96.84	67.49	53.8	159.37	9.53	11.11	22.23	-	-	66.83	313.97	255.59	247.65
MF0111	3	11 1/2"	57.15	146.05	158.75	184.15	58	352.43	466.17	300.66	101.6	63.91	39.6	183.36	12.7	11.11	22.23	6	10.5	96.28	314.88	255.59	247.65
MF0114	1	14"	76.2	171.45	190.5	222.25	85	466.73	530.71	348.36	128.27	54.08	25.4	250.83	12.7	12.7	12.7	6	13.5	65.88	476.46	262.73	247.65
MF0214			88.9	196.85	222.25	251.62	85		656.83	413.46	189.31	54.06		403.14	12.7	12.7	12.7	6	13.5	75.41	477.25	254.79	247.65

Size	G CENTER GRAVITY	MAX SPEED rpm	MAX INPUT TORQUE Nm	WEIGHT kg
MF0110	78	2800	604	56
MF0111	86	2500	770	74
MF0114	111	2300	2045	125
MF0214	148	2300	4089	167

For permissible radial loads apply Transfluid

- No installation related engine thrust bearing damage
- Equipment with ball-bearing engagement collars
- No direct loading to engine crankshaft enhances life of engine bearings
- Dual spherical roller main bearing design
- Driving rings are nodular iron or steel

DIMENSIONS ARE SUBJECT TO ALTERATION WITHOUT NOTICE

CHINA
TRANSFLUID BEIJING TRADE CO.LTD
101300 Beijing
Ph. +86.1060442301-2
Fax +86.1060442305
tbtcinfo@sina.com

FRANCE
TRANSFLUID FRANCE s.a.r.l.
38110 Rochetoirin
Ph. +33.9.75635310
Fax +33.4.26007959
tfrance@transfluid.it

GERMANY
TRANSFLUID GERMANY GmbH
D-48529 Nordhorn
Ph. +49.5921.7288808
Fax +49.5921.7288809
tgermany@transfluid.it

RUSSIA
TRANSFLUID OOO
143100 Moscow
Ph. +7.495.7782042
Mob. +7.926.8167357
trussia@transfluid.it

U.S.A.
TRANSFLUID LLC
Auburn, GA 30011
Ph. +1.770.8221.777
Fax +1.770.8221.774
tfusa@transfluid.it

Global web site: www.transfluid.eu • E-commerce web site: www.buy-transfluid.com